

PLAN #732
FOR THE IMPROVEMENT OF
TWENTY-FOURTH STREET

ARROWHEAD AVENUE TO MOUNTAIN VIEW AVENUE
IN THE
CITY OF SAN BERNARDINO
November 25 1934
CE [Signature] City Engineer
Scale 1"=40'

LEGEND
 * or in means not to be done
 * or P means just or full
 10 means 10 feet
 11 means 11 feet
 12 means 12 feet
 13 means 13 feet
 14 means 14 feet
 15 means 15 feet
 16 means 16 feet
 17 means 17 feet
 18 means 18 feet
 19 means 19 feet
 20 means 20 feet
 21 means 21 feet
 22 means 22 feet
 23 means 23 feet
 24 means 24 feet
 25 means 25 feet
 26 means 26 feet
 27 means 27 feet
 28 means 28 feet
 29 means 29 feet
 30 means 30 feet
 31 means 31 feet
 32 means 32 feet
 33 means 33 feet
 34 means 34 feet
 35 means 35 feet
 36 means 36 feet
 37 means 37 feet
 38 means 38 feet
 39 means 39 feet
 40 means 40 feet
 41 means 41 feet
 42 means 42 feet
 43 means 43 feet
 44 means 44 feet
 45 means 45 feet
 46 means 46 feet
 47 means 47 feet
 48 means 48 feet
 49 means 49 feet
 50 means 50 feet
 51 means 51 feet
 52 means 52 feet
 53 means 53 feet
 54 means 54 feet
 55 means 55 feet
 56 means 56 feet
 57 means 57 feet
 58 means 58 feet
 59 means 59 feet
 60 means 60 feet
 61 means 61 feet
 62 means 62 feet
 63 means 63 feet
 64 means 64 feet
 65 means 65 feet
 66 means 66 feet
 67 means 67 feet
 68 means 68 feet
 69 means 69 feet
 70 means 70 feet
 71 means 71 feet
 72 means 72 feet
 73 means 73 feet
 74 means 74 feet
 75 means 75 feet
 76 means 76 feet
 77 means 77 feet
 78 means 78 feet
 79 means 79 feet
 80 means 80 feet
 81 means 81 feet
 82 means 82 feet
 83 means 83 feet
 84 means 84 feet
 85 means 85 feet
 86 means 86 feet
 87 means 87 feet
 88 means 88 feet
 89 means 89 feet
 90 means 90 feet
 91 means 91 feet
 92 means 92 feet
 93 means 93 feet
 94 means 94 feet
 95 means 95 feet
 96 means 96 feet
 97 means 97 feet
 98 means 98 feet
 99 means 99 feet
 100 means 100 feet

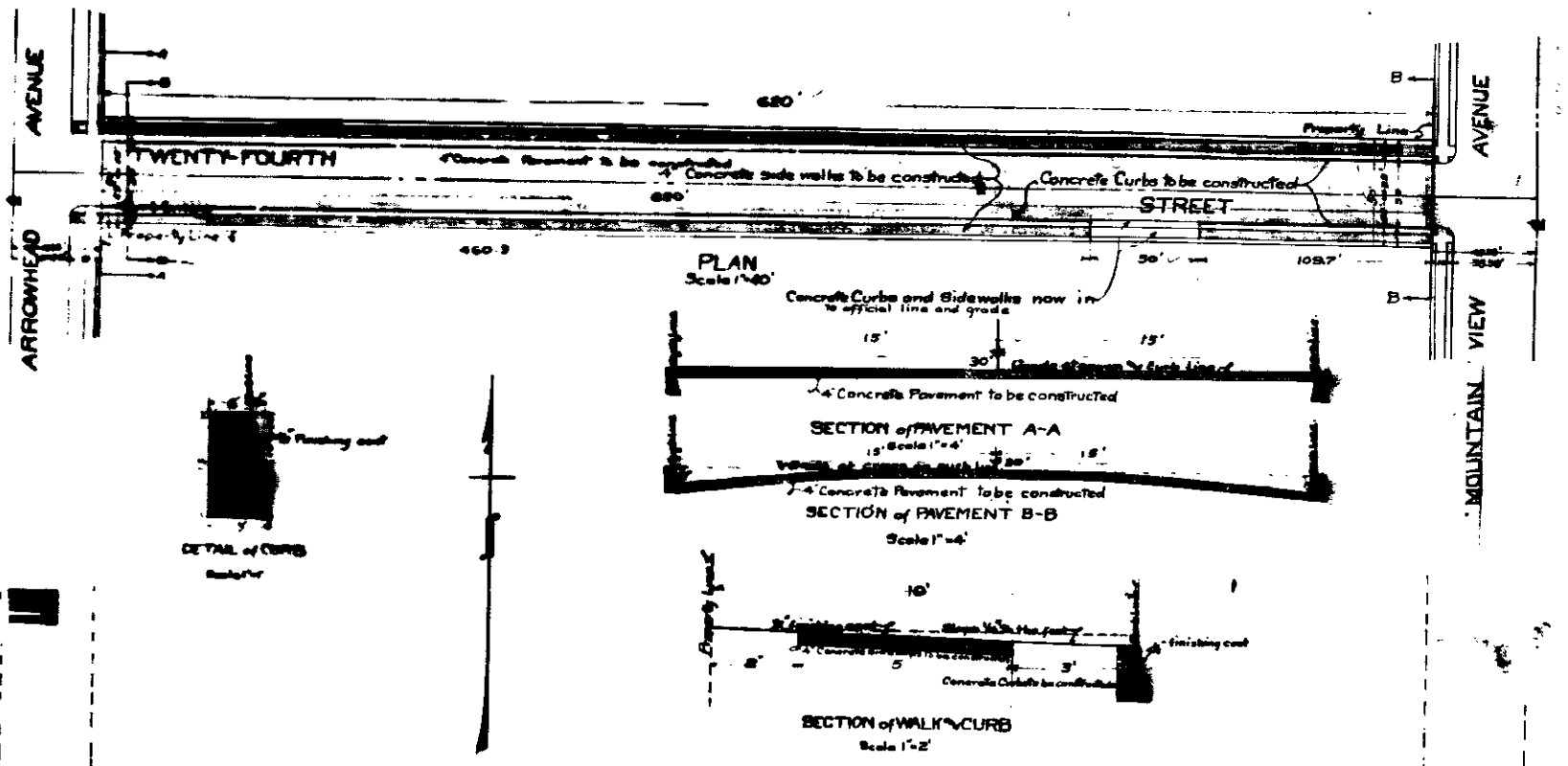

All elevations shown on this plan are in feet and show a plus or minus sign. Elevations below the sea level mark as established by ordinance 385 of the City of San Bernardino, California.

Profile
 Black lines show present surface
 Red lines show grade to which work shall be done
 Horizontal Scale 1"=40'
 Vertical Scale 1"=2'

Work to be Done
 1. Concrete curbs and sidewalks to be constructed along the street.
 2. Concrete pavement to be constructed along the street.
 3. Concrete curbs to be constructed along the street.
 4. Concrete sidewalks to be constructed along the street.
 5. Concrete curbs to be constructed along the street.

Plan adopted December 12, 1934

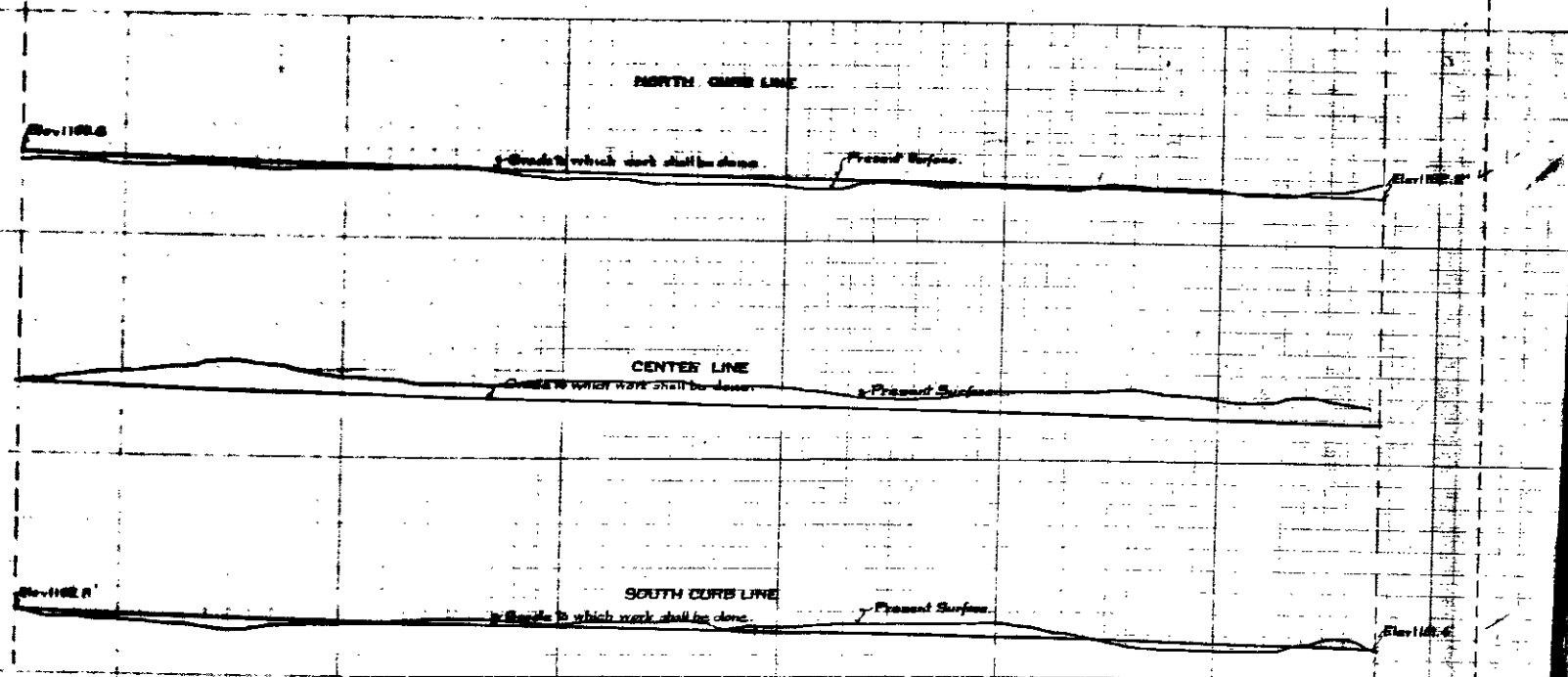

FILED
 [Signature]
 [Date]

PLAN #732
FOR THE IMPROVEMENT OF
TWENTY-FOURTH STREET

ARROWHEAD AVENUE TO MOUNTAIN VIEW AVENUE
IN THE
CITY OF SAN BERNARDINO
November 25 1934
C.E. Johnson
City Engineer
Scale 1"=40'

LEGEND
 * or in means not to be done
 * or P means just or full
 10 means 10 feet
 11 means 11 feet
 12 means 12 feet
 13 means 13 feet
 14 means 14 feet
 15 means 15 feet
 16 means 16 feet
 17 means 17 feet
 18 means 18 feet
 19 means 19 feet
 20 means 20 feet
 21 means 21 feet
 22 means 22 feet
 23 means 23 feet
 24 means 24 feet
 25 means 25 feet
 26 means 26 feet
 27 means 27 feet
 28 means 28 feet
 29 means 29 feet
 30 means 30 feet
 31 means 31 feet
 32 means 32 feet
 33 means 33 feet
 34 means 34 feet
 35 means 35 feet
 36 means 36 feet
 37 means 37 feet
 38 means 38 feet
 39 means 39 feet
 40 means 40 feet
 41 means 41 feet
 42 means 42 feet
 43 means 43 feet
 44 means 44 feet
 45 means 45 feet
 46 means 46 feet
 47 means 47 feet
 48 means 48 feet
 49 means 49 feet
 50 means 50 feet
 51 means 51 feet
 52 means 52 feet
 53 means 53 feet
 54 means 54 feet
 55 means 55 feet
 56 means 56 feet
 57 means 57 feet
 58 means 58 feet
 59 means 59 feet
 60 means 60 feet
 61 means 61 feet
 62 means 62 feet
 63 means 63 feet
 64 means 64 feet
 65 means 65 feet
 66 means 66 feet
 67 means 67 feet
 68 means 68 feet
 69 means 69 feet
 70 means 70 feet
 71 means 71 feet
 72 means 72 feet
 73 means 73 feet
 74 means 74 feet
 75 means 75 feet
 76 means 76 feet
 77 means 77 feet
 78 means 78 feet
 79 means 79 feet
 80 means 80 feet
 81 means 81 feet
 82 means 82 feet
 83 means 83 feet
 84 means 84 feet
 85 means 85 feet
 86 means 86 feet
 87 means 87 feet
 88 means 88 feet
 89 means 89 feet
 90 means 90 feet
 91 means 91 feet
 92 means 92 feet
 93 means 93 feet
 94 means 94 feet
 95 means 95 feet
 96 means 96 feet
 97 means 97 feet
 98 means 98 feet
 99 means 99 feet
 100 means 100 feet

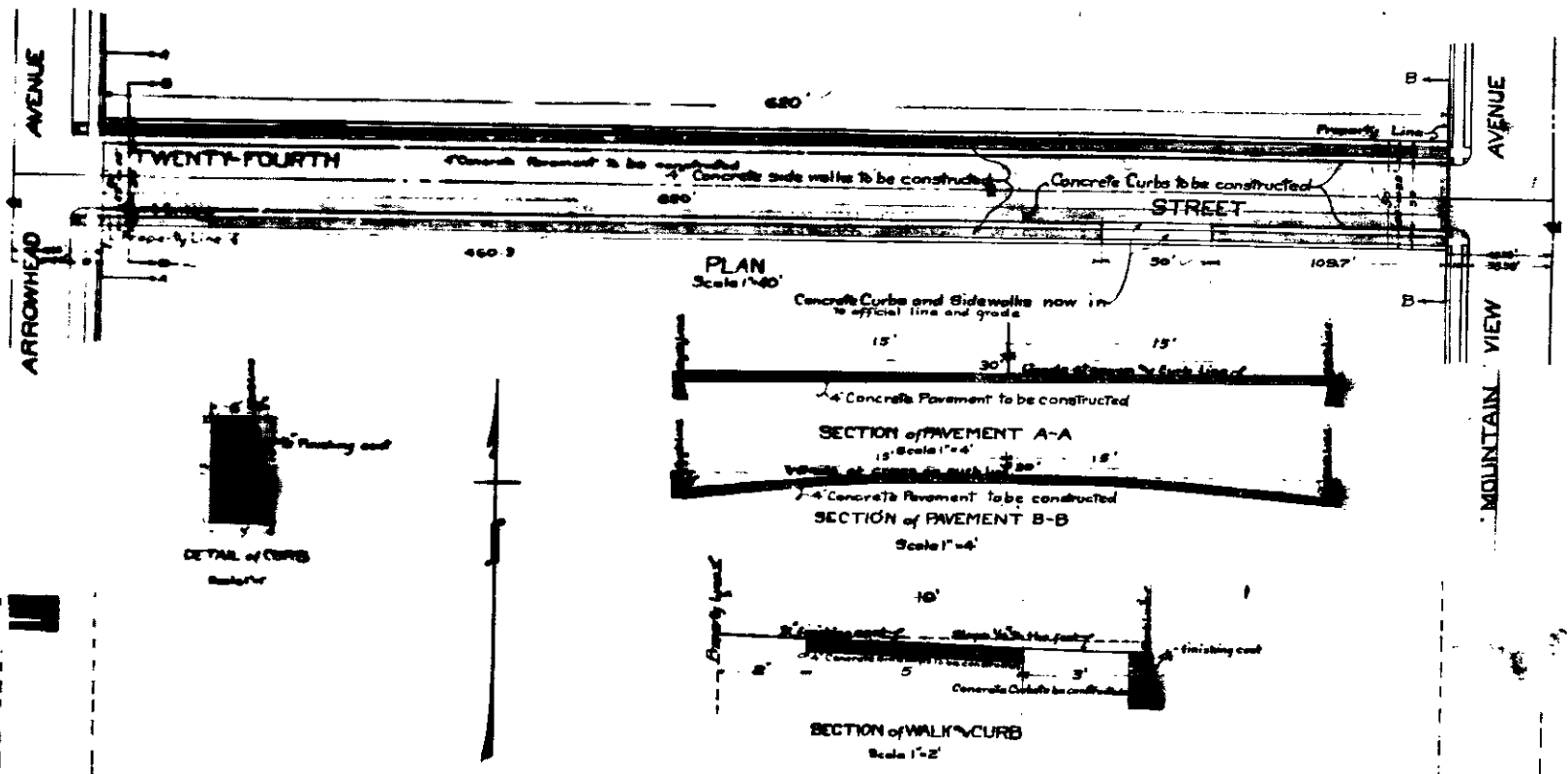

All elevations shown on this plan are in feet and show a plus or minus sign. Elevations below the sea level mark as established by ordinance 385 of the City of San Bernardino, California.

Profile
 Black lines show present surface.
 Red lines show grade to which work shall be done.
 Horizontal Scale 1"=40'
 Vertical Scale 1"=2'

T.M.C. Sheet
 2208 Street detailed by Highway Department.
 Recorded in book 19 of map page 57 Records
 of San Bernardino County.
 Grade on 24" Sheet
 Established April 18 1925 Ordinance 10200

Plan adapted October 12 1934

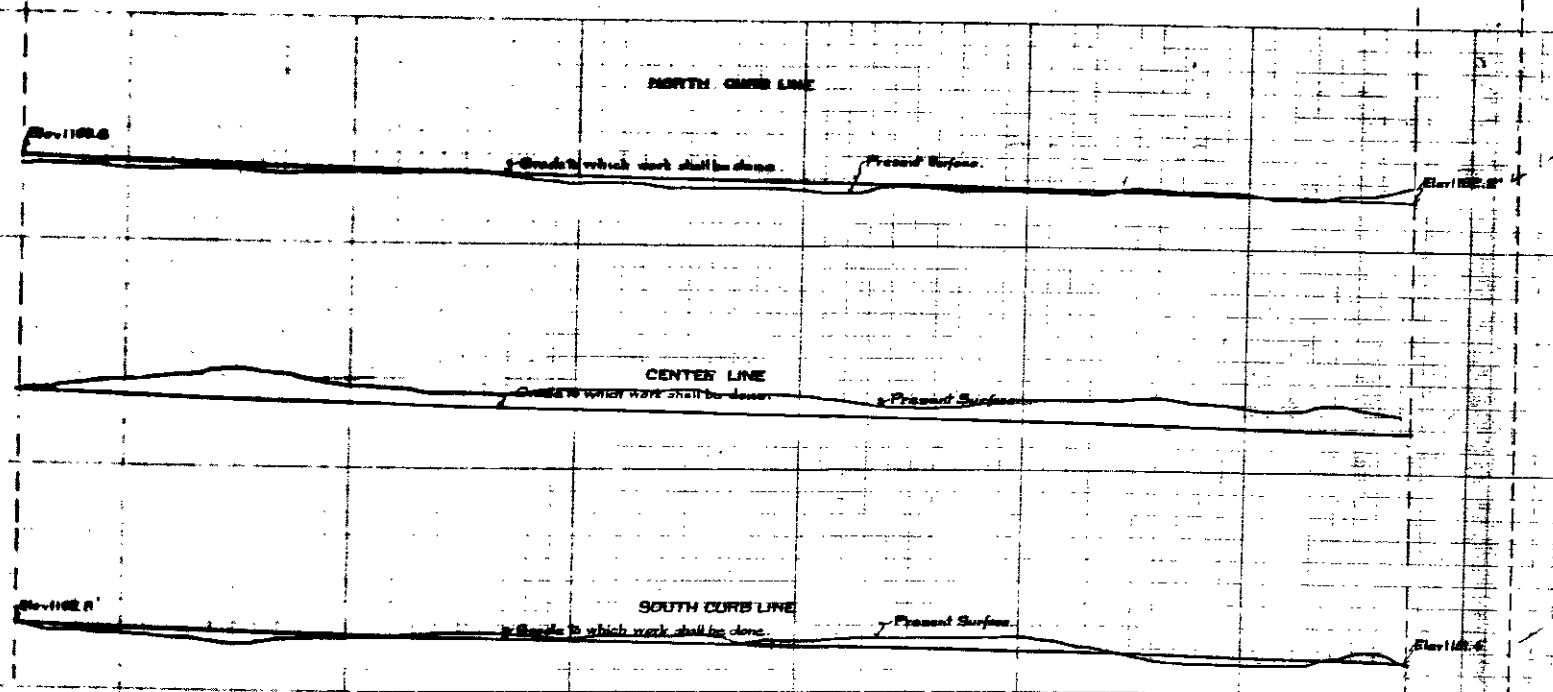

FILED
 11/25/34
 City Engineer

PLAN #732
FOR THE IMPROVEMENT OF
TWENTY-FOURTH STREET

ARROWHEAD AVENUE TO MOUNTAIN VIEW AVENUE
IN THE
CITY OF SAN BERNARDINO
November 25 1934
CE [Signature] City Engineer
Scale 1"=40'

LEGEND
 * or a means not to be done
 * or P means just or full
 10 means 10 feet
 11 on arrow means north
 12 means 12 feet
 13 means 13 feet
 14 means 14 feet
 15 means 15 feet
 16 means 16 feet
 17 means 17 feet
 18 means 18 feet
 19 means 19 feet
 20 means 20 feet
 21 means 21 feet
 22 means 22 feet
 23 means 23 feet
 24 means 24 feet
 25 means 25 feet
 26 means 26 feet
 27 means 27 feet
 28 means 28 feet
 29 means 29 feet
 30 means 30 feet
 31 means 31 feet
 32 means 32 feet
 33 means 33 feet
 34 means 34 feet
 35 means 35 feet
 36 means 36 feet
 37 means 37 feet
 38 means 38 feet
 39 means 39 feet
 40 means 40 feet
 41 means 41 feet
 42 means 42 feet
 43 means 43 feet
 44 means 44 feet
 45 means 45 feet
 46 means 46 feet
 47 means 47 feet
 48 means 48 feet
 49 means 49 feet
 50 means 50 feet
 51 means 51 feet
 52 means 52 feet
 53 means 53 feet
 54 means 54 feet
 55 means 55 feet
 56 means 56 feet
 57 means 57 feet
 58 means 58 feet
 59 means 59 feet
 60 means 60 feet
 61 means 61 feet
 62 means 62 feet
 63 means 63 feet
 64 means 64 feet
 65 means 65 feet
 66 means 66 feet
 67 means 67 feet
 68 means 68 feet
 69 means 69 feet
 70 means 70 feet
 71 means 71 feet
 72 means 72 feet
 73 means 73 feet
 74 means 74 feet
 75 means 75 feet
 76 means 76 feet
 77 means 77 feet
 78 means 78 feet
 79 means 79 feet
 80 means 80 feet
 81 means 81 feet
 82 means 82 feet
 83 means 83 feet
 84 means 84 feet
 85 means 85 feet
 86 means 86 feet
 87 means 87 feet
 88 means 88 feet
 89 means 89 feet
 90 means 90 feet
 91 means 91 feet
 92 means 92 feet
 93 means 93 feet
 94 means 94 feet
 95 means 95 feet
 96 means 96 feet
 97 means 97 feet
 98 means 98 feet
 99 means 99 feet
 100 means 100 feet

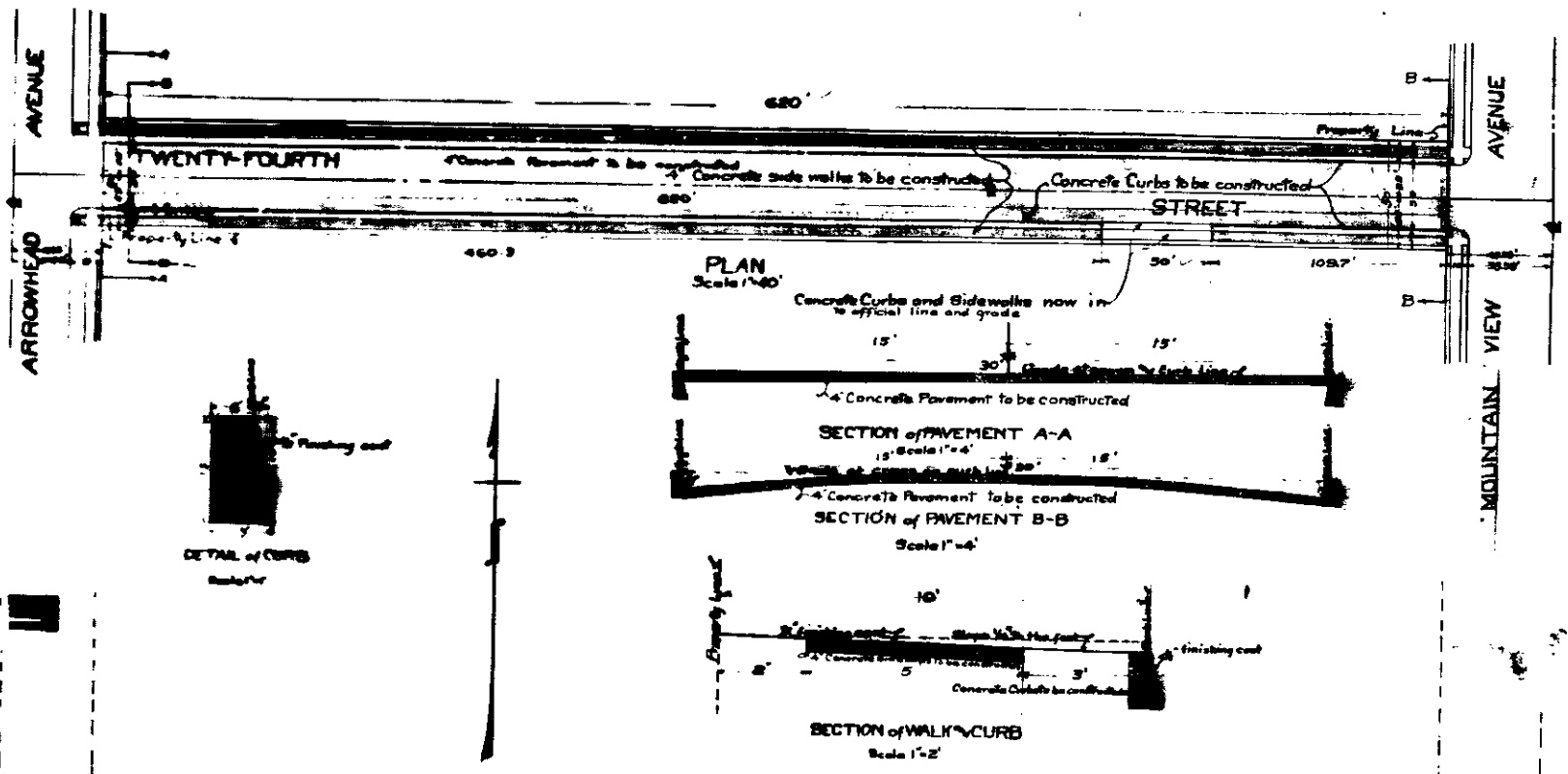

All elevations shown on this plan are in feet and show a plus or minus sign. Elevations below the sea level mark as established by ordinance 385 of the City of San Bernardino, California.

Profile
 Black lines show present surface
 Red lines show grade to which work shall be done
 Horizontal Scale 1"=40'
 Vertical Scale 1"=2'

Vertical Curve
 200' Street designed by Highway Department
 Recorded in book 19 of map page 57 Records
 of San Bernardino County
 Grade of 2.4% Street
 Established April 10 1932 Ordinance 10200

Plan adapted December 12 1934

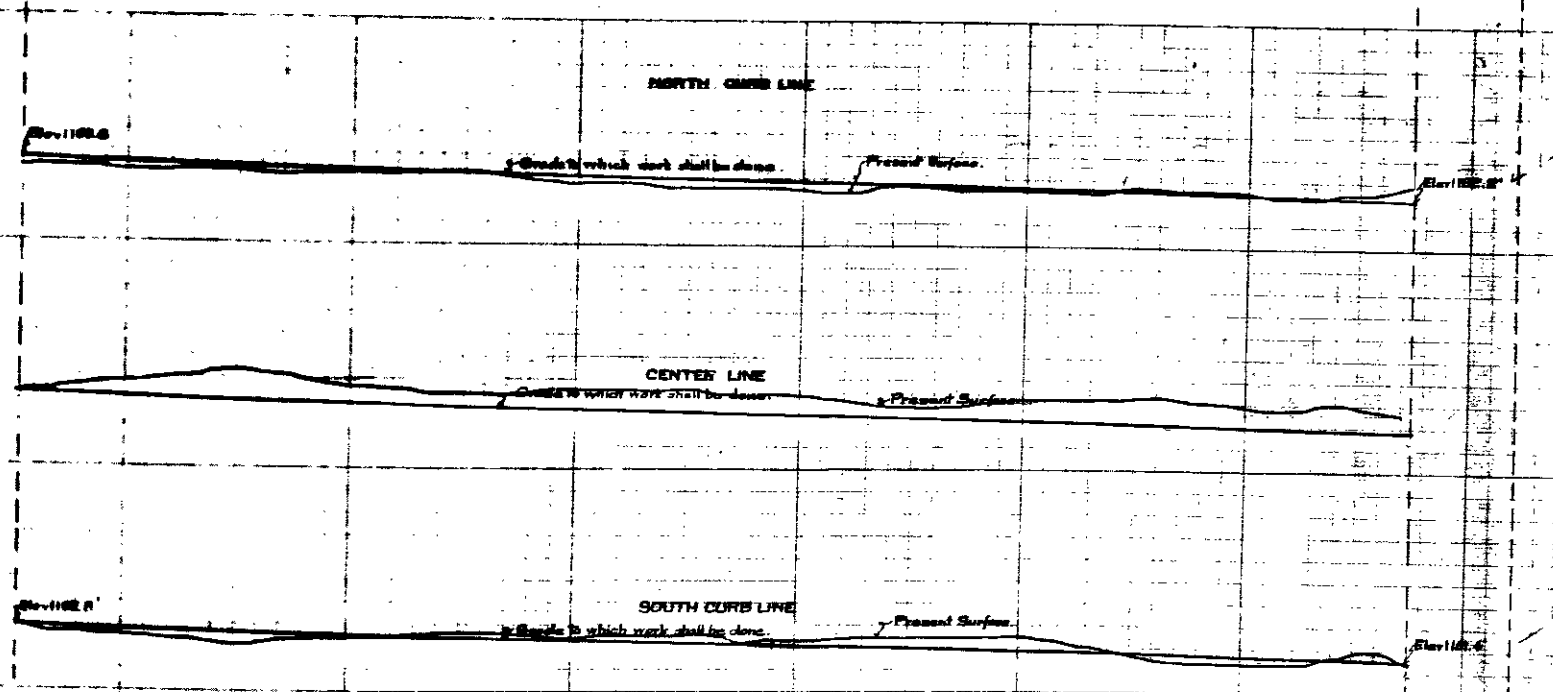

FILED
 [Signature]
 [Date]